

# ILLU-A Art.10024

Trockenbau/Strutture a secco/Dry construction/Cloison sèche

Befestigung des Alu-Profiles an Gipsplatte und Ständerbau  
 Fissaggio del profilo sulle lastre di cartogesso e sul montante  
 Fixing the aluminium profile to the plaster board and the support construction  
 Fixation du profilé en aluminium à la plaque de plâtre et au montant

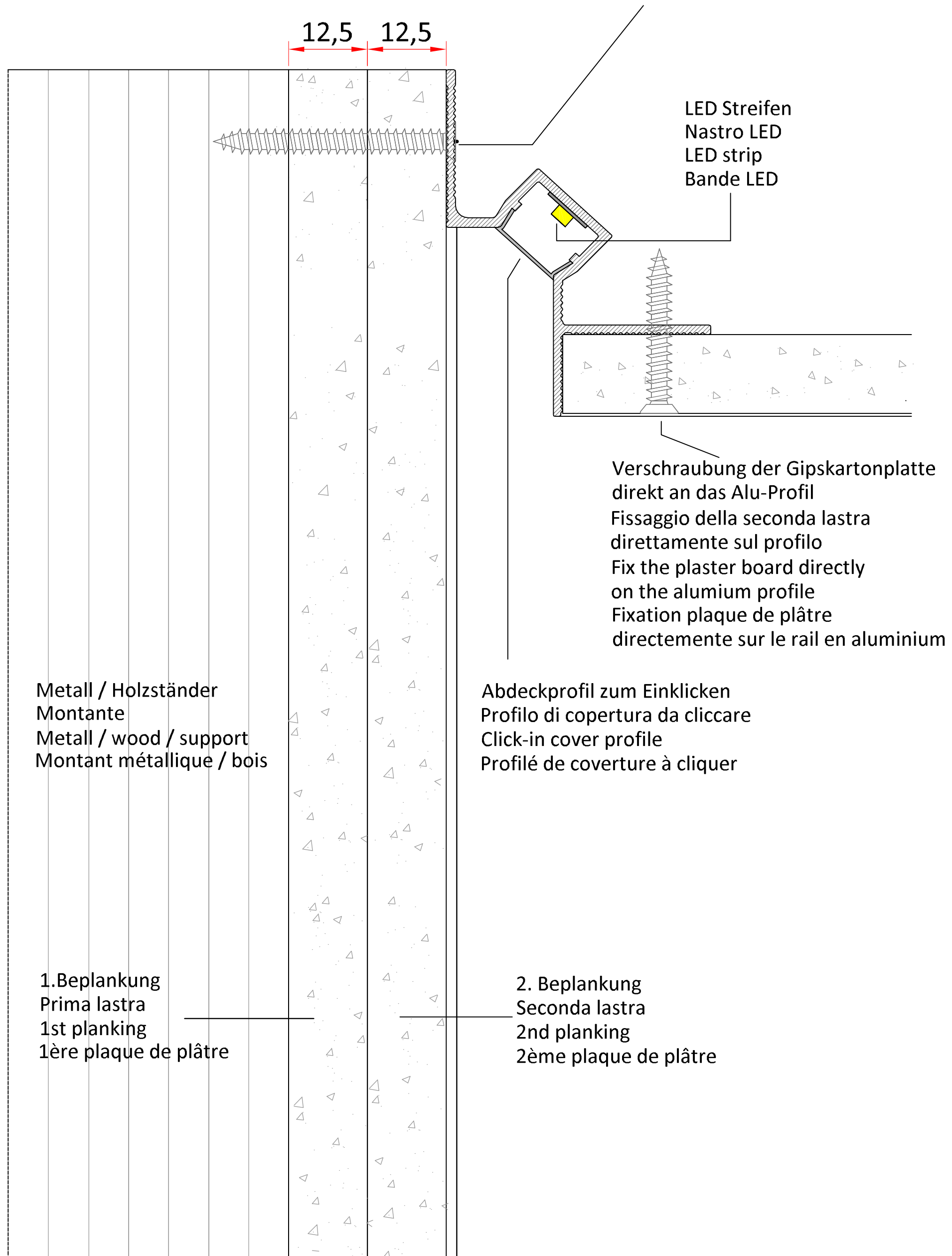

AGS-Systems - 39025 Naturno (Italy)

Drawing	Art. 10024	Scala 1:1	Date	30/07/2024
This drawing is copyright by AGS-systems and exclusive, protected by law and cannot reproduced without written affirmation				AGS-systems - 39025 Naturno (Italy) Stava 47B tel. 0039 0473 666376 - info@ags-systems.com