

Technical data sheet

**Model TST50  
 for inward/outward opening doors**

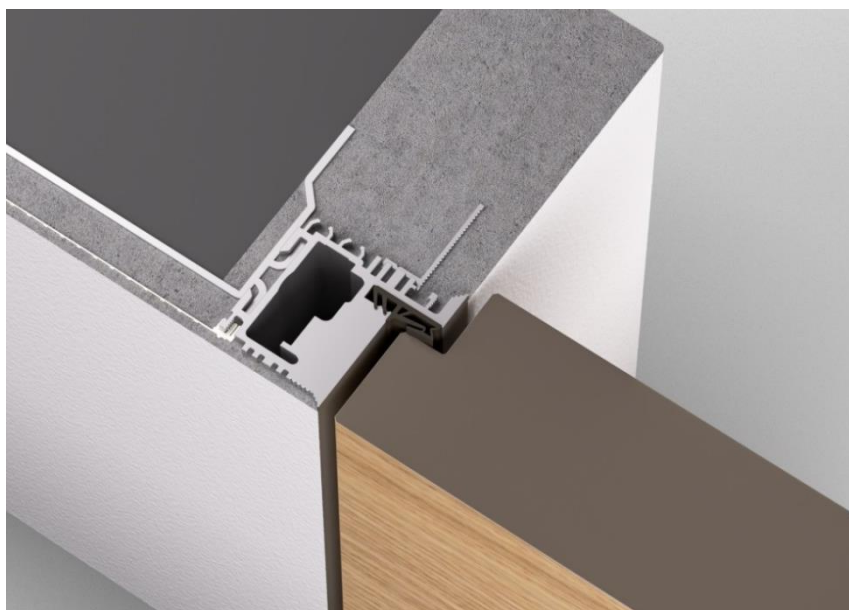

**Index**

Profile detail.....	2
Recommendations .....	2
Suitable hinges .....	3
Suitable striking plates .....	3
Suitable door closers.....	4
Suitable seals .....	5
Door leaf .....	6/7
Inward opening doors .....	6
Outward opening doors.....	7

## Profile detail

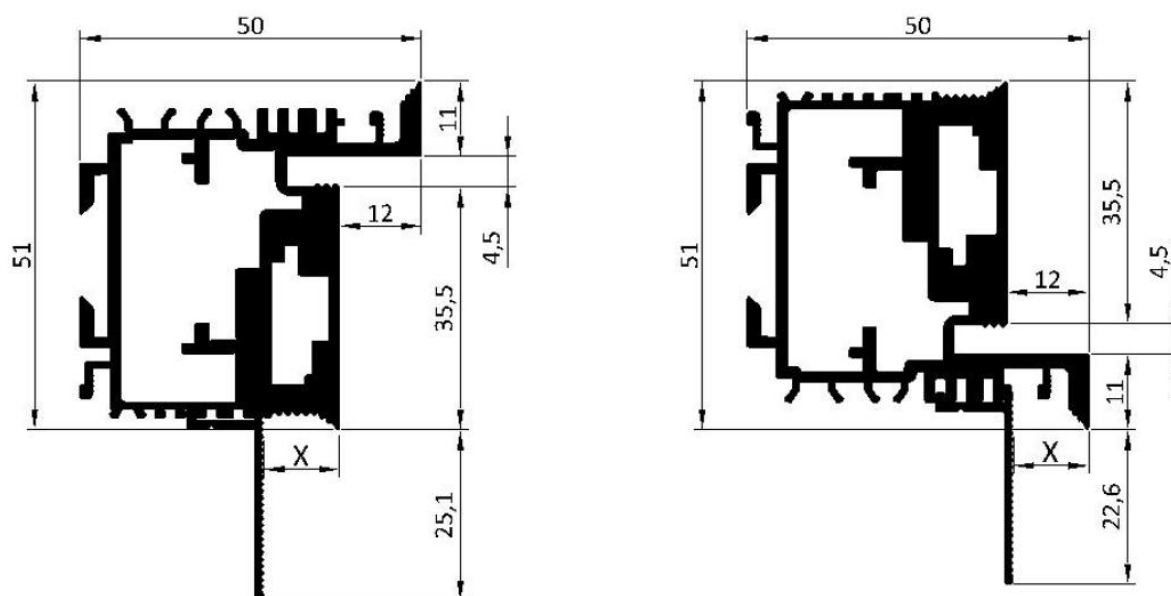

$$X = 11/14 \text{ mm}$$

Model TST50		
Description	Item number	Standard lengths*
TST50	10139	5500 mm

\*Special lengths on request.

Model TST50
<u>Suitable for solid and dry construction</u>
The frame profiles are supplied mitre-cut to suit door size, and machined to suit concealed hinges, lock strikes and other hardware. In combination with the snapIn corner connectors and the mounting brackets, this enables quick assembly and professional installation. The snap-in mesh ensures no plaster cracks between wall and frame. Suits standard or floor-to-ceiling doors.

Here you can find the assembling video:



masonry construction



drywall

## Recommendations

On the basis of detailed tests and long-term experiences our technical office has prepared a recommendation-list regarding the selection of hinges, closing panels and seals. These lists are practical guidelines and non-exhaustive.

<b>RECOMMENDATION</b>		
<b>Suitable hinges</b>		
Producer	Designation	Weight
AGB <a href="http://www.agb.it">www.agb.it</a>	Eclipse 3.2	40/60 kg
Anselmi <a href="http://www.anselmisrl.it">www.anselmisrl.it</a>	AN 150 3D	40 kg
	AN 170 3D	70 kg
Basys <a href="http://www.basys.biz">www.basys.biz</a>	Pivota DX38 „N“ 3-D	60 kg
	Pivota DX38 3-D CP (Design)	60 kg
	Pivota DX42 3-D (Design)	60 kg
	Pivota DX43 3-D (Design)	60 kg
	Pivota DX60 3-D	100 kg
	Pivota DX62 3-D	100 kg
	Pivota DX100 3-D	120 kg
Ceam <a href="http://www.ceamitalia.it">www.ceamitalia.it</a>	1129	40 kg
	1130	40 kg
	1429	35 kg
	1430	60 kg
Krona Koblenz <a href="http://www.kronakoblenz.com">www.kronakoblenz.com</a>	KUBICA KubiCenter - K6400	30 kg
	Kombi Hybrid K1019	40 kg
	Kombi Hybrid K1060	60 kg
	Atomica Slim K8060	60 kg
Simonswerk <a href="http://www.simonswerk.com">www.simonswerk.com</a>	Tectus TE 240 3-D	60 kg
	Tectus TE 340 3-D	80 kg

<b>RECOMMENDATION</b> <b>Suitable striking plates</b>	
Producer	Designation
AGB <a href="http://www.agb.it">www.agb.it</a>	B01402.05.XX
	Minimal XT B02402.05.XX
	Minimal XT B02402.28.XX
Basys <a href="http://www.basys.biz">www.basys.biz</a>	Basys SBL 2-L justierbar V3 li/re magnetic
Bonaiti Serrature SpA <a href="http://www.bonaiti.it">www.bonaiti.it</a>	G996
	G998
	GI98
	GAL1
	GF45
	GF98
	GR95
	GR96
	GR97
Dormakaba <a href="http://www.dormakaba.com">www.dormakaba.com</a>	SB/MAG/120.20.2,0
	SB/MAG/210.20.2,0
	SB/MAG/VR
KFV <a href="http://www.kfv.de">www.kfv.de</a>	FSS 116-120-18HR/41
	FSS 116-120-20HR/41
Simonswerk <a href="http://www.simonswerk.com">www.simonswerk.com</a>	KCM 50
	CM 50/H

<b>RECOMMENDATION</b> <b>Suitable seals/gaskets</b>	
Producer	Designation
Deventer Profile GmbH <a href="http://www.deventer-profile.com">www.deventer-profile.com</a>	DS 6922a
Helmut Goll GmbH <a href="http://www.helmutgoll.com">www.helmutgoll.com</a>	A1020
Primo Profile GmbH <a href="http://www.primo.com">www.primo.com</a>	ACF 5602 H
SchlegelGiesse – Giesse S.p.A <a href="http://www.schlegelgiesse.com">www.schlegelgiesse.com</a>	QL 3096
	QL 3104

## Door leaf

### Inward opening doors

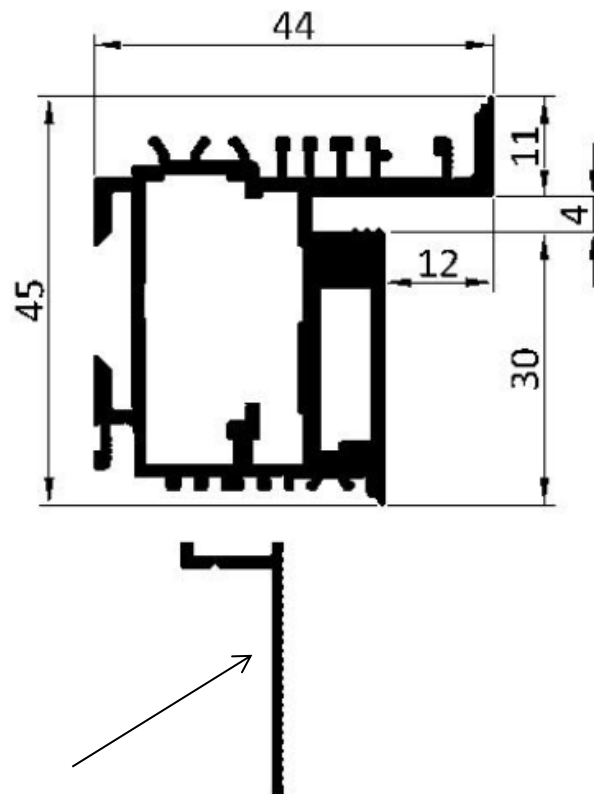

Detachable profile for drywall

Rebate dimension for 5mm door seal

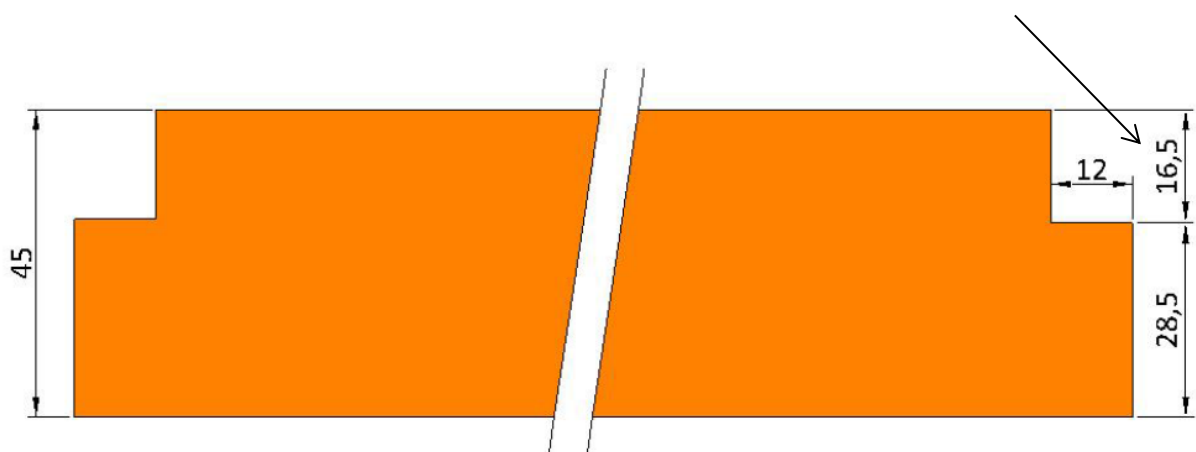

## Outward opening doors

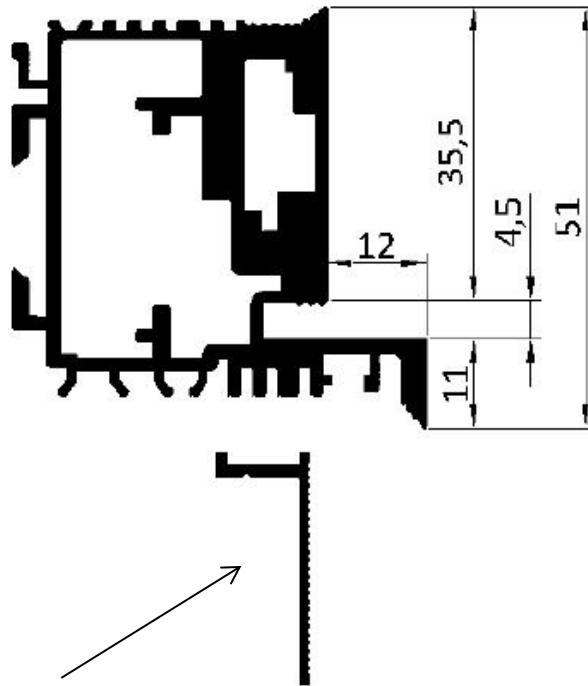

Detachable profile for drywall

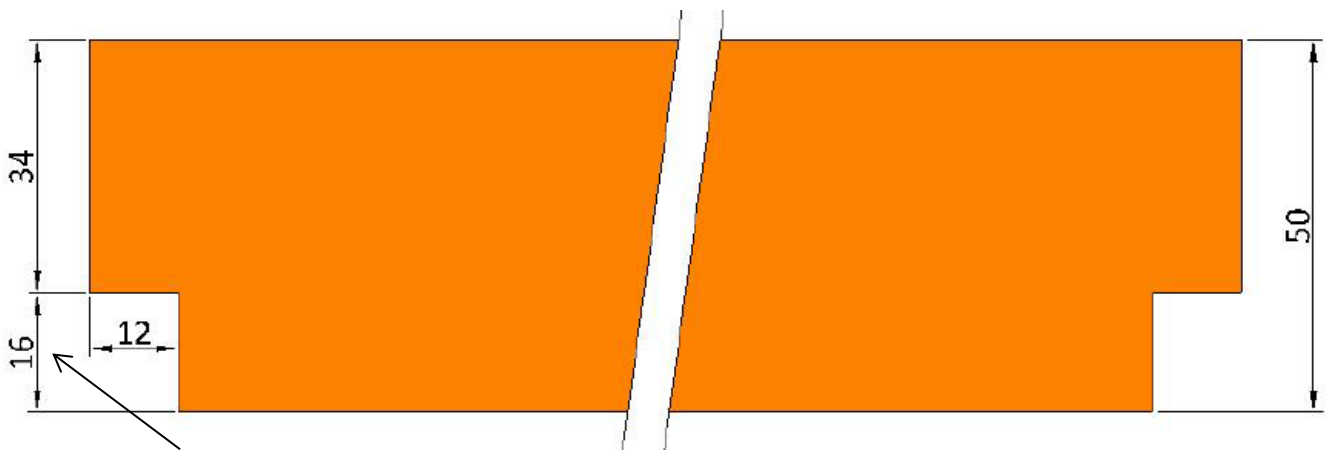

Rebate dimension for 5mm door seal

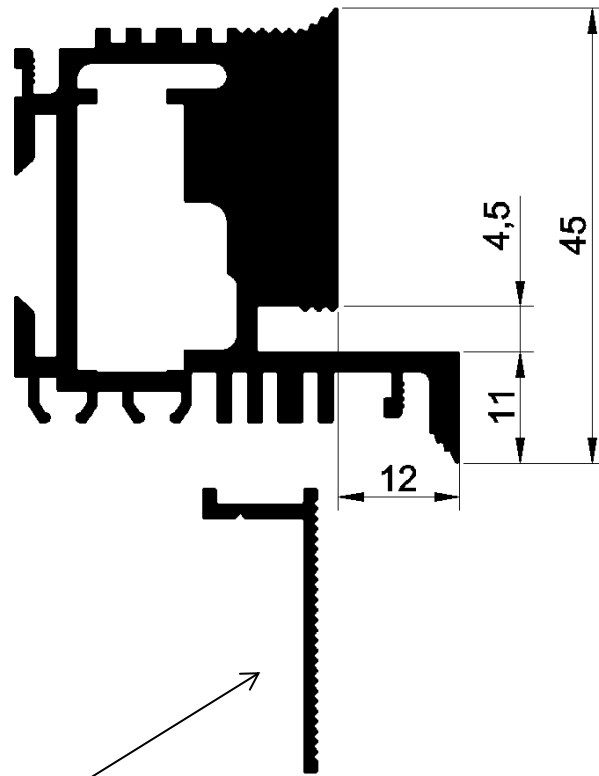

Detachable profile for drywall

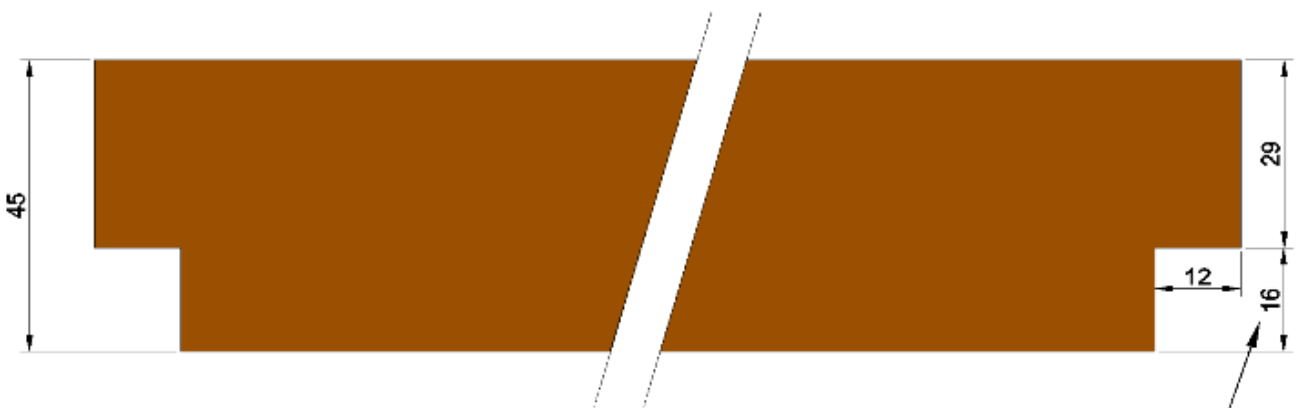

Rebate dimension for 5mm door seal

We guarantee for a high quality of our products. Our processing guidelines are based on tests and practical experiences; they are only indication without assurance of properties, we have no influence on condition of construction sites and the realizations of the works.

Country specific regulations, which consist on regional standards, building regulations, processing and industrial guidelines, can guide to specific processing recommendations.